

BUTLER MUG HOLDER INSTALLATION STEPS FOR THE BMW 1200 LT

Please note that, although this is a very simple procedure, Glass Act will not accept any responsibility for mistakes made that may lead to unsatisfactory results or otherwise damage to any of the motorcycle parts. For assistance with this procedure please call Glass Act at 512-768-3908.

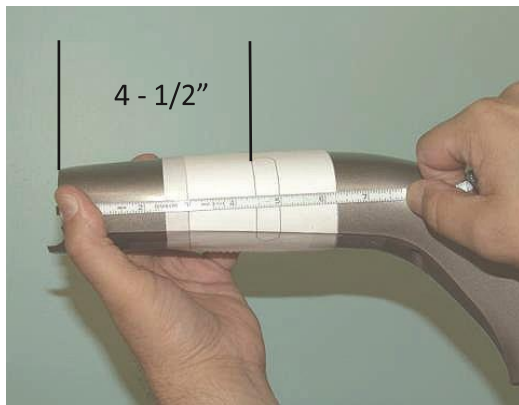

STEP 1:

REMOVE THE PLASTIC HANDLEBAR COVERS FROM THE LEFT HANDLEBAR AND PUT THEM BACK TOGETHER (OFF THE BIKE) USING THE ORIGINAL SCREWS. REMOVE THE TEMPLATE BACKING AND STICK THE TEMPLATE ON THE COVERS AS SHOWN.

CAREFULLY ALIGN THE HORIZONTAL LINE ON THE TEMPLATE WITH THE JOINT BETWEEN THE TWO PIECES OF PLASTIC (THAT IS TO THE INSIDE OF THE HANDLEBAR) AND MAKE THE LEFT VERTICAL LINE OF THE "CUT-OUT" 4 - 1/2" FROM THE END OF THE TOP PIECE OF PLASTIC THAT GOES TOWARD THE HANDLEBAR GRIP.



STEP 2:

USING A ROTARY CUTTING WHEEL (AS IS AVAILABLE WITH A DREMEL TOOL), CAREFULLY CUT ALONG THE VERTICAL LINES OF THE CUT-OUT.



STEP 3:

USING A CYLINDRICAL OR BALL NOSED CUTTING BIT, CAREFULLY TRIM OUT THE ROUNDED ENDS OF THE CUT-OUT.



STEP 4:

FINISH TRIMMING WILL BE REQUIRED. YOU WANT THIS TO BE A CLEAN JOB. IT IS EASY TO DO. AND, EVERYONE SHOULD HAVE A DREMEL, OR SIMILAR ROTARY TOOL. AFTER 40 YEARS OF MACHINE SHOP WORK, I HAVE FOUND THIS TYPE OF TOOL TO BE INDISPENSABLE. EVEN IF YOU ARE NOT INCLINED TO BE A MACHINIST, POSSESSING THIS TYPE OF TOOL WILL PROVE TO BE VERY REWARDING. THEY ARE AVAILABLE AT LOWES, HOME DEPOT, ETC.

STEP 5:

REMOVE THE TEMPLATE - PLACE THE BRASS U-BOLT AROUND THE HANDLEBAR MAKING SURE THAT ALL CABLES ARE OUT OF THE WAY - PLACE THE BLACK DELRIN HALF-SADDLE ON THE U-BOLT, THEN RE-ASSEMBLE THE TWO PIECES OF PLASTIC HANDLEBAR COVERS ON THE BIKE.

YOU MAY NEED TO DO SOME "FINE TUNE" TRIMMING DURING THIS STEP. NOTE THAT THE LEGS OF THE U-BOLT ARE NOT HORIZONTAL TO THE GROUND; THEY TEND TO AIM SLIGHTLY UPWARD. THIS IS THE WAY YOU WANT THEM TO BE. THE SLOT THAT YOU HAVE CUT IN THE PLASTIC WILL CAUSE THIS.

WHAT YOU WANT HERE IS FOR THE PLASTIC COVERS TO NOT BIND IN ANY WAY AGAINST THE DELRIN HALF-SADDLE. SO, TRIM A LITTLE RELIEF IF NECESSARY.

YOU ALSO WANT THE TOP, INSIDE EDGE OF THE DELRIN HALF-SADDLE TO JUST TOUCH THE CUT-OUT IN THE PLASTIC COVER, BUT NOT BE UNDER IT. THIS PLACE IS INDICATED BY THE POINTER ON THE PICTURE.

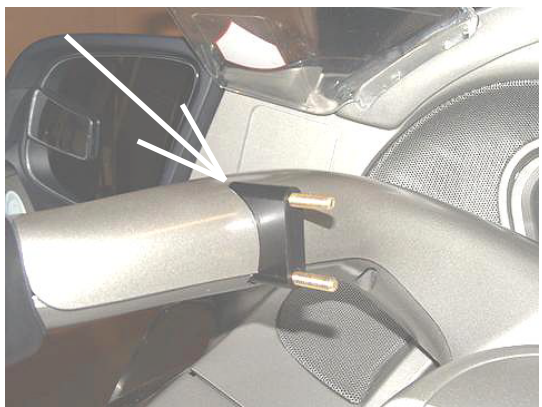

AFTER INSTALLATION OF THE U-BOLT, HALF-SADDLE, AND THE PLASTIC COVERS, FOLLOW THESE INSTRUCTIONS TO ASSEMBLE THE REST OF THE BUTLER SYSTEM

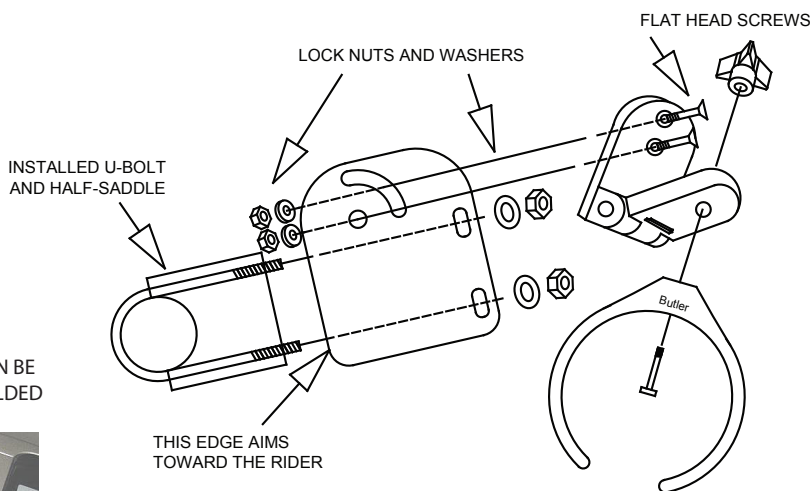

WHEN NOT IN USE, THE RING CAN BE REMOVED AND THE BRACKET FOLDED UP IN THIS POSITION



THE BUTLER DOES NOT INTERFERE WITH OPERATING CONTROLS, FACTORY GPS OR TANK BAGS



WHEN COMPLETE
THE RING SHOULD BE LEVEL WITH THE GROUND AND
AIMING BACK TOWARDS THE RIDER AND TO THE LEFT

